

1 THIRD FLOOR - AREA DIAGRAM ADDITION
SCALE 1:200

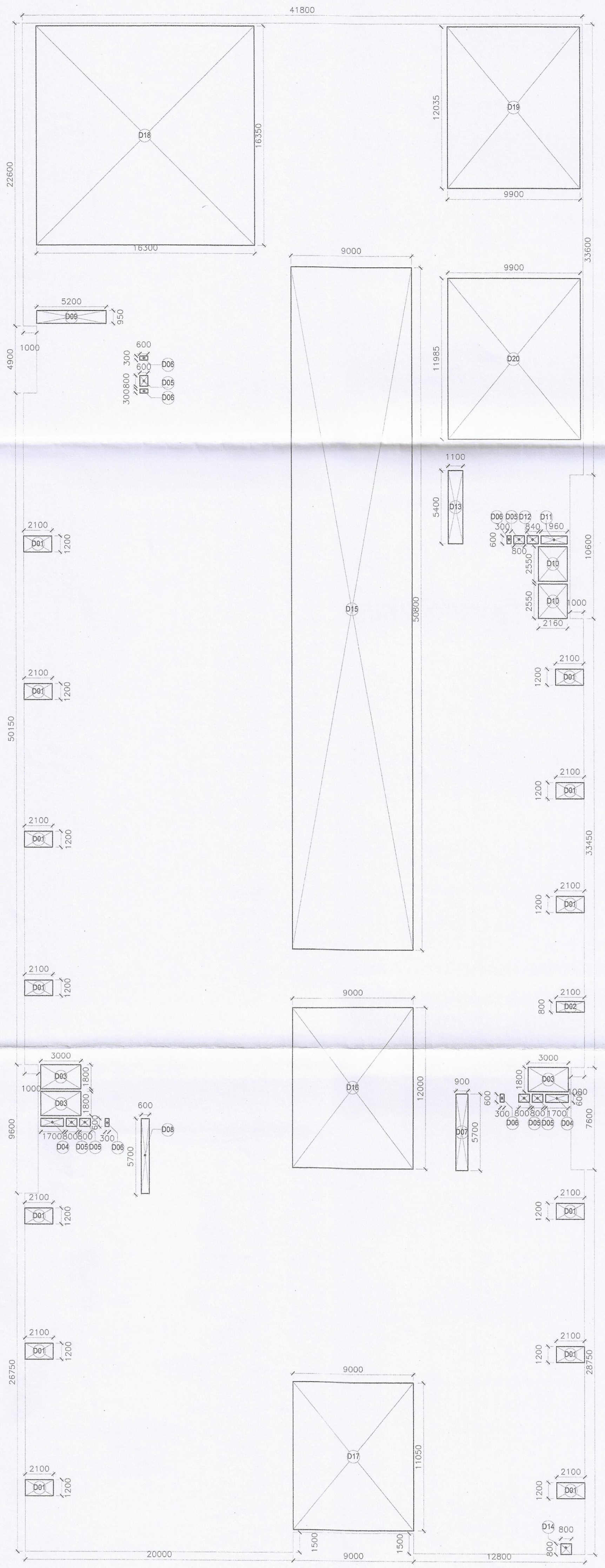

2 THIRD FLOOR - AREA DIAGRAM DEDUCTION
SCALE 1:200

FLOOR AREA RATIO (FAR) CALCULATION- THIRD FLOOR (TABLE-07)						
S.NO.	DESCRIPTION	QUANTITY	X	Y	FORMULA	AREA (SQ. M.)
1	A01	1	41800	22600	Area Rectangle= L X B	944.680
2	A02	1	40800	4900	Area Rectangle= L X B	199.920
3	A03	1	41800	6100	Area Rectangle= L X B	254.980
4	A04	1	40800	10600	Area Rectangle= L X B	432.480
5	A05	1	41800	33450	Area Rectangle= L X B	1398.210
6	A06	1	28000	9600	Area Rectangle= L X B	268.800
7	A07	1	11800	7600	Area Rectangle= L X B	89.680
8	A08	1	20000	26750	Area Rectangle= L X B	535.000
9	A09	1	9000	25350	Area Rectangle= L X B	227.250
10	A10	1	12800	28750	Area Rectangle= L X B	368.000
A	TOTAL ADDITION AREA OF THIRD FLOOR (A)					4719.000

S.NO.	DESCRIPTION	QUANTITY	X	Y	FORMULA	AREA (SQ. M.)
1	D01	13	2100	1200	Area Rectangle= L X B	32.760
2	D02	1	2100	0.800	Area Rectangle= L X B	1.680
3	D03	3	3000	1.800	Area Rectangle= L X B	16.200
4	D04	2	1700	0.600	Area Rectangle= L X B	2.040
5	D05	6	0.800	0.600	Area Rectangle= L X B	2.880
6	D06	5	0.300	0.600	Area Rectangle= L X B	0.900
7	D07	1	0.900	5.700	Area Rectangle= L X B	5.130
8	D08	1	0.600	5.700	Area Rectangle= L X B	3.420
9	D09	1	5.200	0.950	Area Rectangle= L X B	4.940
10	D10	2	2.160	2.550	Area Rectangle= L X B	11.016
11	D11	1	1.960	0.600	Area Rectangle= L X B	1.176
12	D12	1	0.840	0.600	Area Rectangle= L X B	0.504
13	D13	1	1.100	5.400	Area Rectangle= L X B	5.940
14	D14	1	0.800	0.800	Area Rectangle= L X B	0.640
15	D15	1	9.000	96.000	Area Rectangle= L X B	864.000
16	D16	1	9.000	12.000	Area Rectangle= L X B	108.000
17	D17	1	9.000	11.050	Area Rectangle= L X B	99.450
18	D18	1	16.300	16.350	Area Rectangle= L X B	266.505
19	D19	1	9.900	11.985	Area Rectangle= L X B	118.652
20	D20	1	9.900	11.985	Area Rectangle= L X B	118.652
B	TOTAL DEDUCTION AREA ON THIRD FLOOR (B)					1258.179
C	NET FAR AREA ON THIRD FLOOR (C=A-B)					3460.821

(Handwritten signatures and stamps)
 Sub-Assistant Engineer
 Jaipalguri Zilla Parishad
 District Engineer
 Jaipalguri Zilla Parishad

(FOR SOIL ONLY)

<p>PROJECT CODE: 209</p> <p>1. This Drawing and Design is the Property of the Designers. No Portion may be used or Reproduced without their Written Permission.</p> <p>2. All Dimensions are to be Verified onsite by the Contractor. Any Discrepancies are to be Reported to the Designers Immediately.</p> <p>3. This Drawing is to be Read in Conjunction with the Designers Specifications, Conditions of Contract and Relevant Consultant Drawings.</p> <p>4. Drawings not Showing the Latest Revisions are to be Cancelled.</p> <p>5. All Dimensions are to be Read not Scaled.</p> <p>6. All Indicated Levels are Finished Levels unless Noted Otherwise.</p> <p>7. Architect is not responsible for any deviation in area (built, structural, marketing etc).</p> <p>8. Any and All deviations from municipal drawings is understood to be made of behalf of client request with prior information provided to the client by architect about legal implications. Architect in no way whatsoever can be held responsible for such deviations.</p> <p>9. All fire fighting arrangements are kept as per latest NBC.</p>	<p>SCHEDULE OF LAND</p> <p>VOLTA: SHIMOGAM KARNATAKA NO. 1813 (REGD) 10/9 PLOT NO. 1813/109 (1813/109/1) 2ND, 3RD, 4TH, 5TH, 6TH, 7TH, 8TH, 9TH, 10TH, 11TH, 12TH, 13TH, 14TH, 15TH, 16TH, 17TH, 18TH, 19TH, 20TH</p> <p>SCHEME PLOT NO. 1813/109/1 (1813/109/1)</p> <p>ILL. NO. 109 (REGD) 19/01/81</p> <p>BLOCK: RAJAGAN DIST: JALPAIGURI PS: NEW JALPAIGURI</p>	<p>DECLARATION OF GEO-TECHNICAL ENGINEER</p> <p>I, ADROIT GHOSH, a duly qualified and registered Professional Engineer, Class-I, in the State of West Bengal, India, and also under the supervision of the relevant authority and after the receipt of the necessary information and after the site visit and inspection, hereby declare that the soil bearing capacity and the soil conditions of the site are as stated in the above report and the same are true and correct.</p> <p>Adroit Ghosh Geotechnical Engineer, Class-I Registration No. 170 170, Mainak Mitra Road, Sankar, Mob. No. 98323 76105 adroitghosh@hotmail.com</p>	<p>DECLARATION OF OWNER</p> <p>I, Urban Shapers LLP, a duly qualified and registered Professional Engineer, Class-I, in the State of West Bengal, India, and also under the supervision of the relevant authority and after the receipt of the necessary information and after the site visit and inspection, hereby declare that the soil bearing capacity and the soil conditions of the site are as stated in the above report and the same are true and correct.</p> <p>Urban Shapers LLP Geotechnical Engineer, Class-I Registration No. 170 170, Mainak Mitra Road, Sankar, Mob. No. 98323 76105 adroitghosh@hotmail.com</p>	<p>DECLARATION OF STRUCTURAL ENGINEER</p> <p>I, Sanjay Bhardwaj, a duly qualified and registered Professional Engineer, Class-I, in the State of West Bengal, India, and also under the supervision of the relevant authority and after the receipt of the necessary information and after the site visit and inspection, hereby declare that the structural design of the building is as stated in the above report and the same are true and correct.</p> <p>Sanjay Bhardwaj Structural Engineer, Class-I Registration No. 1524 ESR-1524 of KMC ESR-(1), 1524 STRUC. Rev.-SMCA/1</p>	<p>PROJECT TITLE/INFORMATION:</p> <p>1213/9, FIRST FLOOR, ABOVE HDFC BANK LADD SARAI, NEW DELHI-110030 1/2: 91 11 41401053 W: www.team3.in</p> <p>ARCHITECT:</p> <p>Team3</p>	<p>LOCATION:</p> <p>UTSOSHAMRA, PHASE-I, KAWAKHAR, DIST- JALPAIGURI.</p> <p>DRAWING TITLE:</p> <p>THIRD FLOOR PLAN</p> <p>DRAWING STATUS:</p> <p>SANCTION DWG.</p> <p>PROJECT STARTED: 2023 SCALE: 1:200</p> <p>CHECKED: RAHUL DEALT: RAJWAN</p> <p>DRAWING NO. A--1.5A</p> <p>13 DEC, 2023</p>
---	---	---	--	---	--	--

HILLVIEW LEISURE PVT. LTD.
 DIRECTOR
 SUMAN MFG. WORKS LTD.
 Director
 Vireet Bansal
 DIRECTOR